

NOTES :

GENERAL

OUTPUT TO THE INSTRUMENT FROM THE PREAMP IS UNITY GAIN, NORMAL POLARITY.

WHEN A COMBINATION ELECTRODE IS USED, REFERENCE CONNECTION IS MADE THROUGH THE BNC CONNECTOR. USE OF A SEPARATE REFERENCE REQUIRES A CONNECTION TO TERMINAL 1, AS SHOWN IN DRAWING AT LEFT.

TEMPERATURE COMPENSATION

STANDARD TB7 TC IS ACCOMPLISHED WITH A POSITIVE COEFFICIENT 3,000Ω @ 25°C BALCO ELEMENT, CONNECTED TO THE INSTRUMENT.

SHIELDING

TAKE CARE NOT TO ALLOW THE BNC SHIELD (REFERENCE LEAD) TO CONTACT METAL PIPING OR J-BOXES AT ANY POINT, AS THIS WILL SHORT THE REFERENCE CELL TO EARTH GROUND, AND CAUSE UNSTABLE READINGS.

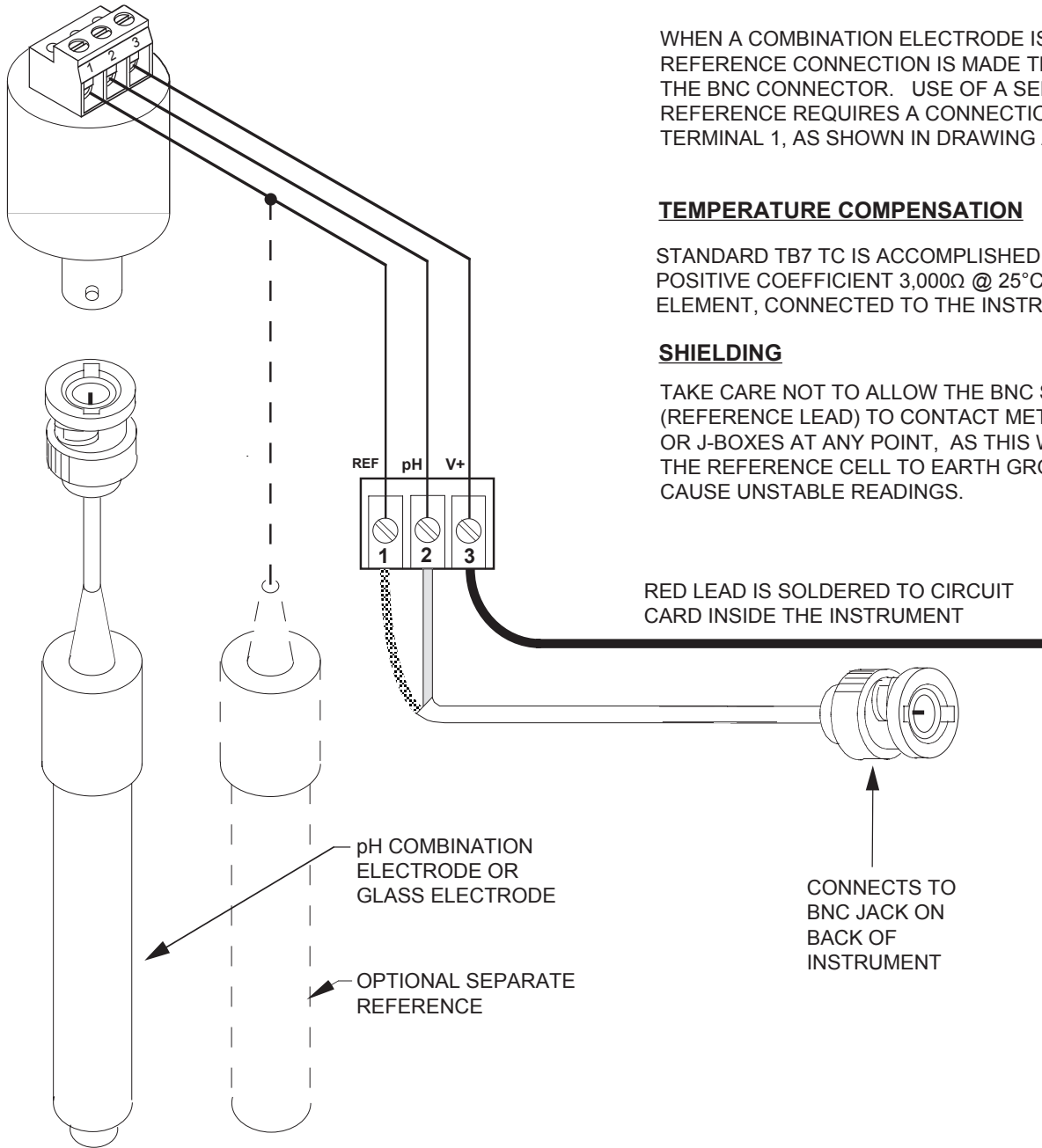

RED LEAD IS SOLDERED TO CIRCUIT CARD INSIDE THE INSTRUMENT

CONNECTS TO BNC JACK ON BACK OF INSTRUMENT



11751 Markon Drive
Garden Grove, CA. 92841 USA
phone: 714-895-4344 fax: 714-894-4839

DRAWN	TITLE	11751 Markon Drive	
CHECKED	PREAMPLIFIER WIRING U698-03 w/TBI MODEL TB7	Garden Grove, CA. 92841 USA	
APPROVED		phone: 714-895-4344 fax: 714-894-4839	
	SCALE	DRAWING NO.	REV.
	NONE	U698-03-TB7	/
	SHEET		
	1 OF 1		